

SA Branch Saddles



IPEX electrofusion products are engineered smarter than traditional fusion systems. Friatec SA Branch Saddle sizes range from 3" to 8". The product line includes 6" x 4" and 8" x 4" IPS configurations. Pipe sizes 3-8" come with Undersaddle. Sizes 10-22" require top loading tool.. SA Branch Saddles are available with either a 2", 3" or 4" outlet.

Field of Application Installation of service and branch pipes

Range of Application Gas up to 125 psi, Water up to 200 psi

Friatec Molded Saddle Fittings may be clamped onto pipes up to SDR 11 and sealed using electrofusion.

SA Branch Saddles (inches)

Nominal Pipe d1	Main Size d2	Nominal Outlet	Product Code	d3	L	h	t	B1	B2
† 3"	IPS	2 IPS	228184	1.969	4.055	8.150	2.756	6.102	5.906
† 4"	IPS	2 IPS	228185	1.929	4.291	9.173	2.205	6.890	7.087
† 4"	DIP	2 IPS	228296	1.929	4.291	9.173	2.205	6.890	7.087
† 6"	IPS	3 IPS	228180	2.717	5.079	11.496	3.937	8.543	9.646
† 6"	IPS	4 IPS	228277	3.543	5.512	12.256	4.291	9.055	10.433
† 8"	IPS	4 IPS	228276	3.543	5.512	14.256	4.370	11.220	11.024
* 10" – 20"	DIP	2 IPS	228182	2.402	4.567	–	3.150	–	7.874
* 10" – 22"	IPS	2 IPS	228182	2.402	4.567	–	3.150	–	7.874
* 10" – 20"	DIP	3 IPS	228187	2.402	4.567	–	3.150	–	7.874
* 10" – 22"	IPS	3 IPS	228187	2.402	4.567	–	3.150	–	7.874

* FRIATEC Pneumatic Top-loading tool required

† Comes with undersaddle

The saddle of the FRIATEC Safety Fittings can be fused to all PE pipes SDR range 11 through 17.6.

The end of the outlet can be electrofused to all PE pipes SDR range 11 through 17.6.

PE pipes of different melt index groups can be joined.

FEATURES / BENEFITS:

- Compact construction
- SDR11
- HDPE saddle with exposed heating element for optimal heat transfer
- Extra wide fusion zone
- Full pressure rating – 200 psi water, 125 psi gas
- NSF-61

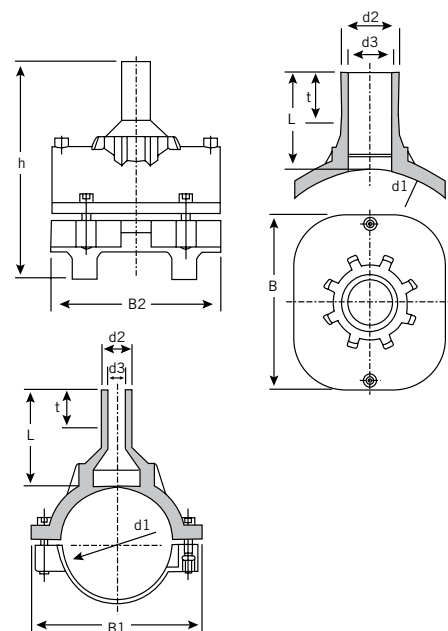

IPEX
by aliaxis

Aliaxis: Parent company

Aliaxis Germany formally Friatec / Manufacture of the Frialen Safety Fitting product line of Couplings, Saddles, Tees and tooling

Innogaz Manufacture of the IPEX EFS Tapping Tee.

IPEX distributor and manufacture of Electrofusion products in North America for sister companies in Aliaxis family, and partner for product and training and support.

About IPEX by Aliaxis

As leading suppliers of thermoplastic piping systems, IPEX by Aliaxis provides our customers with some of the world's largest and most comprehensive product lines. All IPEX by Aliaxis products are backed by more than 50 years of experience. With state-of-the-art manufacturing facilities and distribution centers across North America, we have earned a reputation for product innovation, quality, end-user focus and performance. .

Markets served by IPEX by Aliaxis products are:

- Electrical systems
- Telecommunications and utility piping systems
- Industrial process piping systems
- Municipal pressure and gravity piping systems
- Plumbing and mechanical piping systems
- Electrofusion systems for gas and water
- Industrial, plumbing and electrical cements
- Irrigation systems
- PVC, CPVC, PP, PVDF, PE, ABS, and PEX pipe and fittings

Products manufactured by IPEX Inc. and distributed in the United States by IPEX USA LLC.

This literature is published in good faith and is believed to be reliable. However, it does not represent and/or warrant in any manner the information and suggestions contained in this brochure. Data presented is the result of laboratory tests and field experience.

A policy of ongoing product improvement is maintained. This may result in modifications of features and/or specifications without notice.